



Hollow (Center Hole) Ram (Compression Spring Return)

Maximum Operating working Pressure 10,000 psi/700 Bar

Design pressure 700 bars.

Alloy steel hydraulic cylinder - hardened & tempered, hard chrome plated & honed to fine finish.

Alloy steel piston – hardened & tempered, hard chrome plated, ground.

End Connection 3/8" NPT female (coupler half female optional extra)

Specified shut height & stroke controlled within +/- 3mm

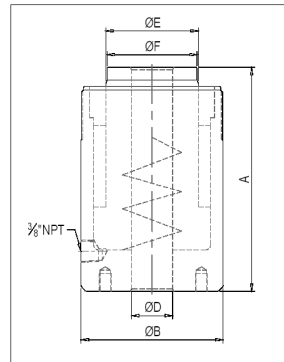

Specification

Model	Capacity		Stroke (mm)	Oil Capacity (cc)	Closed Height (A)	Cylinder OD (B)	C Hole Dia (D)	Ram Dia (E)	Saddle Dia (F)	Saddle Thread (Dia X Pitch) (M1)	Weight (Approx) (Kgs)	Ram Thread (M2)	Thread Depth (L2)	Collar Thread (M3)	Length (L3)	Base Mounting Hole		
	Tonnes	(mm)														Length (M4)	Depth (L4)	PCD (H)
MJH-10/05C	10	50	79	160	75	21	50	48	M20X2.0	4.5	M42*2	22	M75*2	30	M8	15	60	
MJH-10/08C	10	75	118	185	75	21	50	48	M20X2.0	5.0	M42*2	22	M75*2	30	M8	15	60	
MJH-10/10C	10	100	157	210	75	21	50	48	M20X2.0	5.6	M42*2	22	M75*2	30	M8	15	60	
MJH-20/05C	20	50	165	165	105	28	75	73	M27X3	9.1	M56*2	22	M105*2	30	M10	17	85	
MJH-20/10C	20	100	330	215	105	28	75	73	M27X3	11.5	M56*2	22	M105*2	30	M10	17	85	
MJH-20/15C	20	150	495	265	105	28	75	73	M27X3	13.9	M56*2	22	M105*2	30	M10	17	85	
MJH-30/05C	30	50	213	185	115	34	80	77	M33X3	13.3	M64*2	30	M115*2	36	M10	17	95	
MJH-30/08C	30	75	320	210	115	34	80	77	M33X3	14.8	M64*2	30	M115*2	36	M10	17	95	
MJH-30/10C	30	100	426	235	115	34	80	77	M33X3	16.3	M64*2	30	M115*2	36	M10	17	95	
MJH-30/15C	30	150	639	285	115	34	80	77	M33X3	19.3	M64*2	30	M115*2	36	M12	20	95	
MJH-50/08C	50	75	589	220	150	42	100	97	M48X3	26.0	M80*2	30	M150*3	40	M12	20	125	
MJH-50/10C	50	100	785	245	150	42	100	97	M48X3	28.4	M80*2	30	M150*3	40	M12	20	125	
MJH-60/08C	60	75	648	235	165	54	110	107	M48X3	31.6	M90*2	33	M165*3	40	M12	20	135	
MJH-60/10C	60	100	864	260	165	54	110	107	M48X3	34.3	M90*2	33	M165*3	40	M12	20	135	
MJH-60/15C	60	150	1296	310	165	54	110	107	M48X3	39.7	M90*2	33	M165*3	40	M12	20	135	
MJH-100/08C	100	75	1060	265	215	77	150	146	M64X3	62.4	M120*2	40	M215*3	50	M16	24	180	
MJH-100/10C	100	100	1413	290	215	77	150	146	M64X3	67.2	M120*2	40	M215*3	50	M16	24	180	

HYDRAULIC HAND PUMP

Hydraulic hand pump with heavy-duty construction with hardened and ground piston, renewable suction, delivery relief and release valve parts.

Usable displacement/stroke at rated pressure 2.8cc.

Integral reservoir of adequate oil capacity.

Automatic safety valve to cut the pressure at set pressure.

Provision to connect pressure gauge, if required.



Hand Pump Specification

MHHP-91- Single speed, discharge/stroke 2.8cc, total reservoir capacity 1.8 liters, usable capacity 1 liter approx.

MHHP-151-Single speed, stroke 2.8cc, total reservoir capacity 2.2 liters, usable capacity 1.8 liter approx.

MHHP-202-Two stage, output/stroke up to 30 bar 53 cc, output/stroke above 30 bar 2.8cc, total reservoir capacity 3 liter, usable capacity 2 liter approx.

MHHP-402-Two stage, output/stroke up to 30 bar 53 cc, output/stroke above 30 bar 2.8cc, total reservoir capacity 5 liter, usable capacity 3.5 liter approx.

MHHP-502-Two stage, output/stroke up to 30 bar 53 cc, output/stroke above 30 bar 2.8cc, total reservoir capacity 8 liter, usable capacity 5 liter approx.

MHHP-1002- Two stage, output/stroke up to 30 bar 53 cc, output/stroke above 30 bar 2.8cc, total reservoir capacity 13 liter, usable capacity 10.0 liter approx.

HYDRAULIC HOSE

Industrial multilayer hose with 700-bar Maximum Working Pressure with 3/8" NPT Male connection at both end along with spring guards. Burst pressure tested to 1500 bars minimum.

PRESSURE GAUGE (OPTIONAL)

Pressure Gauge 0-980 Bar glycerine filled with stand pipe with end fittings

All the hoses & quick coupler are of the European origin.